

# R40XL Short Face To Face Ball Valve

Formerly **093**

Sizes 1½ through 3 inch, ANSI Class 150

Tufline fully lined short face-to-face valves provide efficient, reliable service in corrosive applications where space is an important consideration.

Refer to page 18 for pressure-temperature ratings.

## Actuation Torques

(Max. breakaway, inch-pounds)

Size	in/lb
1½	137
2	274
3	602
4	274

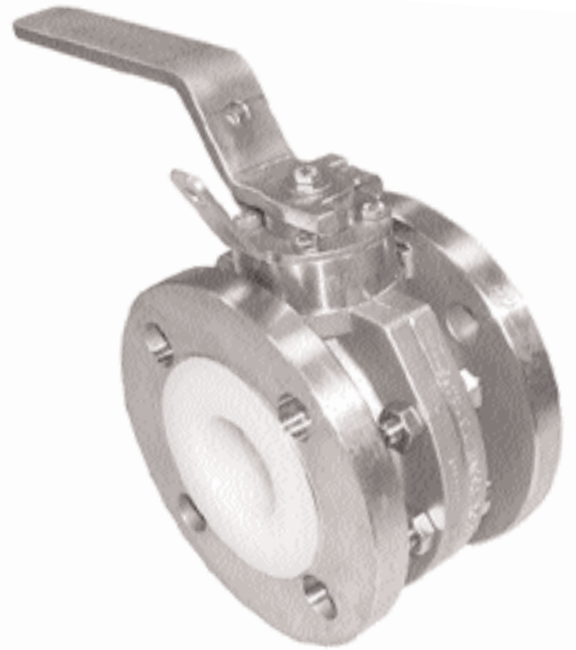
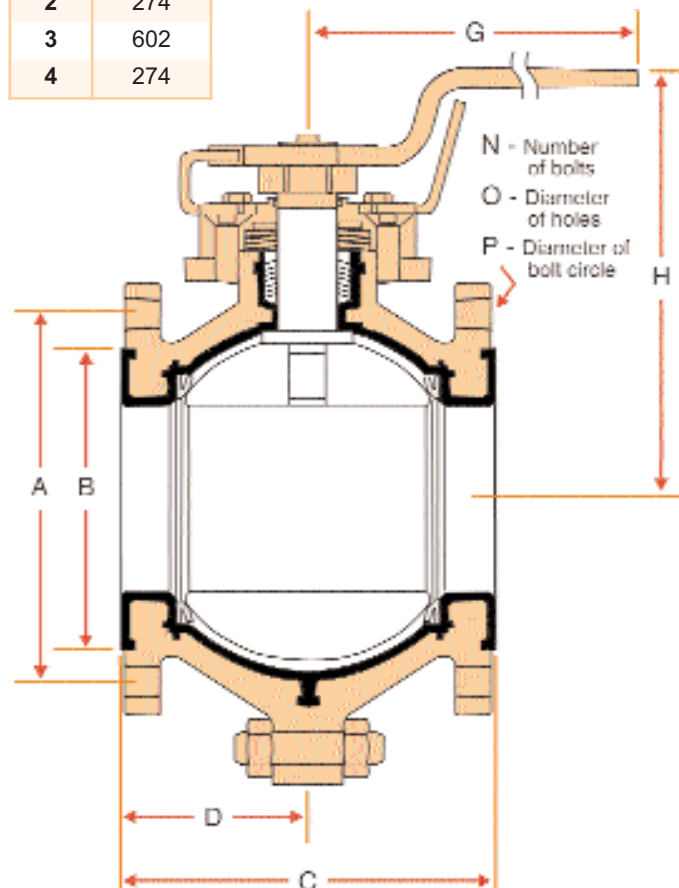

## Materials of construction

Body	PFA lined stainless steel
Ball	PFA lined stainless steel
Stem	PFA lined stainless steel (CD4MCu)
Handle	Stainless steel
Fasteners	Stainless steel
Stem packing	PTFE
Seats	PTFE

Other lining materials available upon request.

Size	A	B	C	D	G	H	N	O	P	Wt. lbs.	Cv Values
1½	4.33	3.54	3.94	1.97	7.85	5.26	4	0.62	3.86	15	213
2	4.92	4.02	4.33	2.17	7.85	5.73	4	0.75	4.72	22	295
3	6.30	5.43	5.91	2.95	11.42	7.52	8	0.75	5.98	47	629
4	7.09	6.30	7.48	3.74	15.75	8.66	8	0.75	7.50	86	1395